

CONTRACTOR SHALL FOLLOW TXDOT DETAILS FOR SWPPP EROSION CONTROL MEASURES WHILE WORKING IN THE ROW.

UTILITY LOCATIONS SHOWN ON PLAN ARE BASED ON FIELD AND DOCUMENT RESEARCH AND MAY BE NEITHER ACCURATE NOR COMPLETE. CONTRACTOR IS FULLY RESPONSIBLE FOR PHYSICALLY LOCATING THE HORIZONTAL AND VERTICAL LOCATION OF ALL UTILITIES IN THE CONSTRUCTION VICINITY PRIOR TO ANY WORK.

ONE-CALL NOTIFICATION SYSTEM  
CALL BEFORE YOU DIG!!!  
(713) 223-4567 (In Houston)  
(New Statewide Number Outside Houston)  
1-800-545-6005

TRENCH SAFETY SYSTEMS  
IT IS THE CONTRACTOR'S RESPONSIBILITY TO PREPARE SHOP DRAWINGS FOR THE "TRENCH SAFETY SYSTEM" AS REQUIRED BY O.S.H.A. BY A LICENSED PROFESSIONAL ENGINEER IN THE STATE OF TEXAS, RETAINED AND PAID BY THE CONTRACTOR.



PLEASE NOTE: CONTRACTOR SHALL COORDINATE ANY DOMESTIC WATER CONNECTION SERVICES WITH CITY OF HITCHCOCK IF ANY SERVICES EXISTS WHILE INSTALLING THE NEW WATER LINE.

PLEASE NOTE: NO BORING OF UTILITIES WITHIN 10' OF THE EDGE OF ASPHALT.

NO DISCHARGE ALLOWED TO TXDOT ROW. IF CONTRACTOR NEEDS TO DISCHARGE TO TXDOT ROW, CONTRACTOR WILL NEED TO OBTAIN A PERMIT FROM TXDOT WITH EXACT LOCATIONS OF PROPOSED DISCHARGE.

- PLEASE NOTE:
- CONTRACTOR SHALL STAKE THE ROW PRIOR TO ANY WORK IN THE ROW. CONTRACTOR TO FIELD VERIFY ALL UTILITIES.
  - UTILITIES THAT RUN UNDER THE DITCH CENTERLINE MUST BE INSTALLED WITH 5' MIN COVER.
  - ALL DITCHES & ROW. SHALL BE REGRADED TO RESTORE POSITIVE FLOW, AND HYDROSEEDED TO RESTORE GRASS GROWTH.
  - CONTRACTOR IS RESPONSIBLE FOR FOLLOWING ALL OF TXDOT RULES FOR BEDDING AND BACKFILL.
  - CONTRACTOR RESPONSIBLE FOR ANY LABORATORY TESTING, WHETHER COMPACTION, OR UTILITY TESTING.
  - CONTRACTOR RESPONSIBLE FOR SCHEDULING PROPER INSPECTIONS WITH TXDOT, AND CITY OF HITCHCOCK.
  - THESE NOTICES ARE FOR ALL PROPOSED WORK IN TXDOT ROW, AND ON PRAIRIE STREET.
  - CONTRACTOR TO VERIFY ALL ROAD ELEVATIONS, AND BENCHMARK DATA. IF ANY DISCREPANCIES EXIST, CONTRACTOR SHALL CONTACT THE ENGINEER.

REVISIONS AND ISSUANCE		
NO.	DATE	DESCRIPTION

PROPRIETARY INFORMATION  
DESIGN INFORMATION CONTAINED HEREIN IS THE EXCLUSIVE PROPERTY OF JRH ENGINEERING, INC. NO PORTION OF ANY DESIGN INFORMATION CONTAINED HEREIN MAY BE USED BY, OR DISCLOSED TO, UNAUTHORIZED PERSONNEL WITHOUT EXPRESSED WRITTEN CONSENT.

ENCHANTED TRAILS RV PARK & RESORT  
0 F.M. 519 (MAIN STREET)  
HITCHCOCK, TX 77563



3/1/23

JRH ENGINEERING & ENVIRONMENTAL SERVICES, INC.  
820 S. FRIENDSWOOD DR. #202  
FRIENDSWOOD, TEXAS 77546  
PHONE: 281-482-8800  
TBPE FIRM NO. 10385

DRAWING TITLE  
**FM519 WATER LINE**  
STA 5+00 TO 10+00  
SCALE: 1:20  
CHECKED BY: [Signature]  
DATE: 3-27-2023  
PROJECT #: 1403369  
DRAWING NO.: **C20.2**

STA	5+00	6+00	7+00	8+00	9+00	10+00
18						
16						
14						
12						
10						
8						
6						
4						
2						
0						
-2						

<ul style="list-style-type: none"> <li> 3" C900 SAN. SEWER FORCEMAIN</li> <li> 3" 11Deg BEND</li> <li> (8"x6") WATERLINE REDUCER</li> <li> (8") PUBLIC WATERLINE C-900 DR-18</li> <li> 8" HORIZONTAL BEND W/ THRUST BLOCK</li> </ul>	<ul style="list-style-type: none"> <li> 518.5 FT</li> <li> 2.0</li> <li> 1.0</li> <li> 399.0 FT</li> <li> 2.0</li> </ul>
--	--

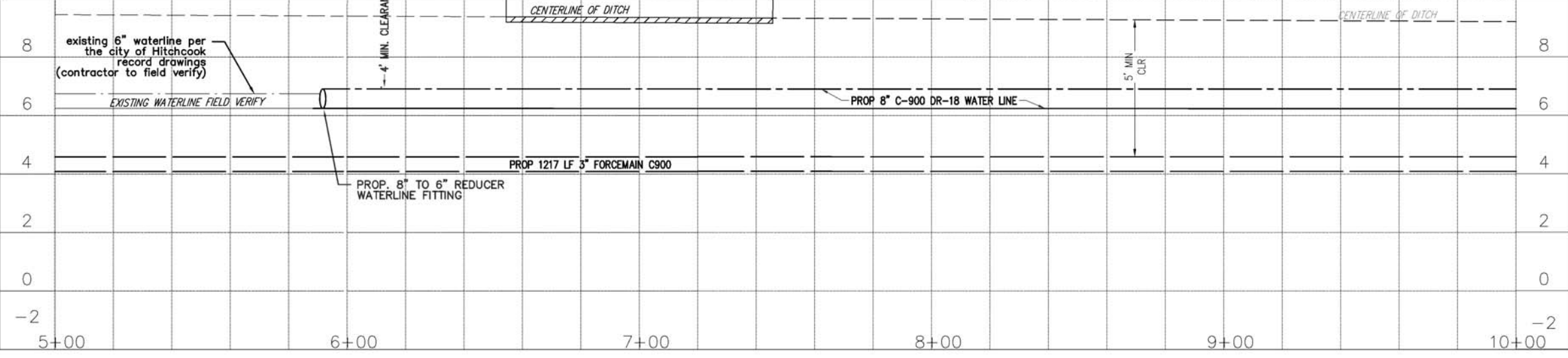

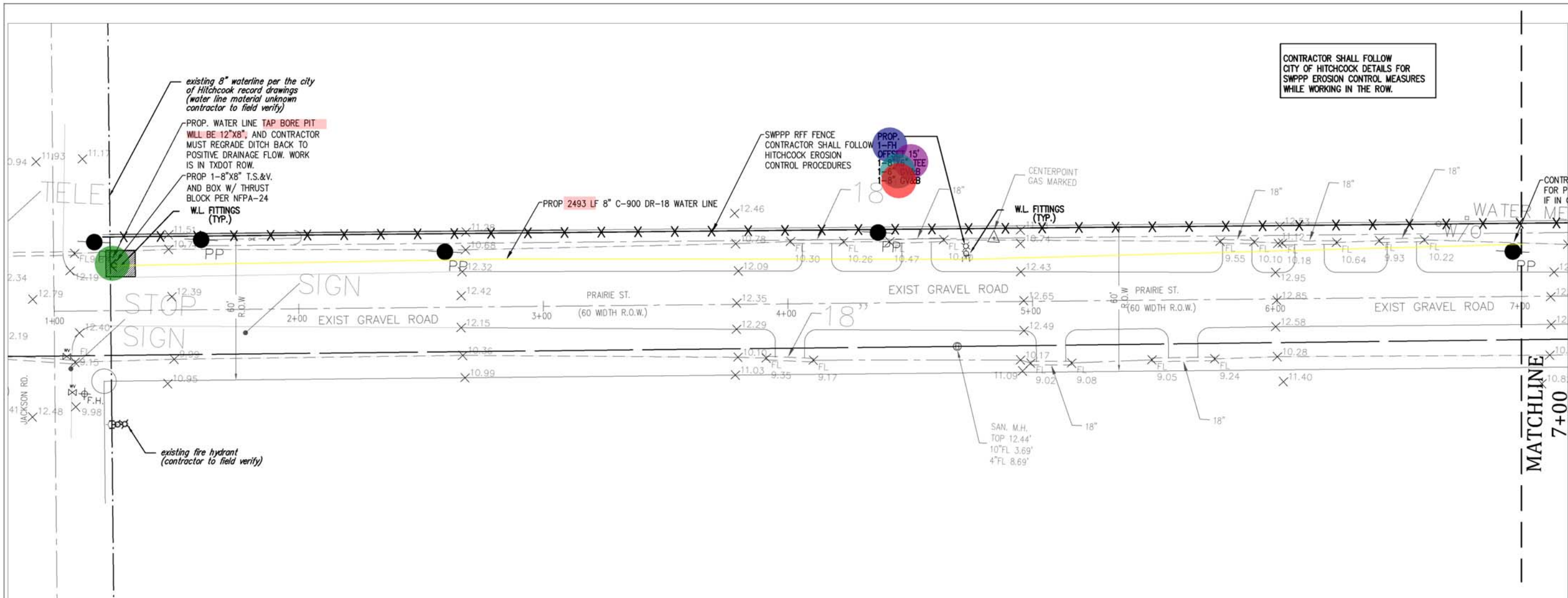

REVISIONS AND ISSUANCE		
NO.	DATE	DESCRIPTION

PROPRIETARY INFORMATION  
 DESIGN INFORMATION CONTAINED HEREIN IS THE EXCLUSIVE PROPERTY OF JRH ENGINEERING, INC. NO PORTION OF ANY DESIGN INFORMATION CONTAINED HEREIN MAY BE USED BY, OR DISCLOSED TO, UNAUTHORIZED PERSONNEL WITHOUT EXPRESSED WRITTEN CONSENT.

ENCHANTED TRAILS RV PARK & RESORT  
 0 F.M. 519 (MAIN STREET)  
 HITCHCOCK, TX 77563



JRH ENGINEERING & ENVIRONMENTAL SERVICES, INC.  
 820 S. FRIENDSWOOD DR. #202  
 FRIENDSWOOD, TEXAS 77546  
 PHONE: 281-482-8800  
 TBPE FIRM NO. 10385

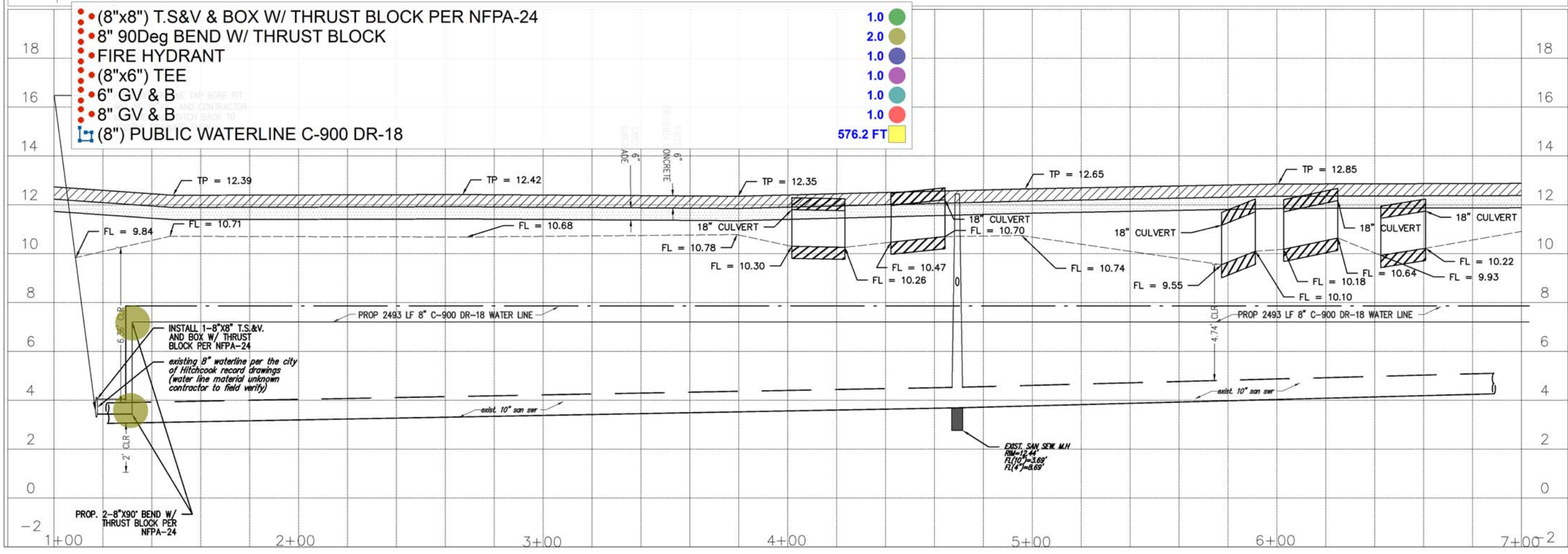

- (8"x8") T.S&V & BOX W/ THRUST BLOCK PER NFPA-24
- 8" 90Deg BEND W/ THRUST BLOCK
- FIRE HYDRANT
- (8"x6") TEE
- 6" GV & B
- 8" GV & B
- ▭ (8") PUBLIC WATERLINE C-900 DR-18

- 1.0 ●
- 2.0 ●
- 1.0 ●
- 1.0 ●
- 1.0 ●
- 1.0 ●
- 576.2 FT ▬

DRAWING TITLE  
**PRAIRIE ST. WATER LINE**  
 STA 0+00 TO 7+00

SCALE 1:20 CHECKED BY

DATE 4-24-2023 PROJECT # 1403369

DRAWING NO.  
**C20.6**

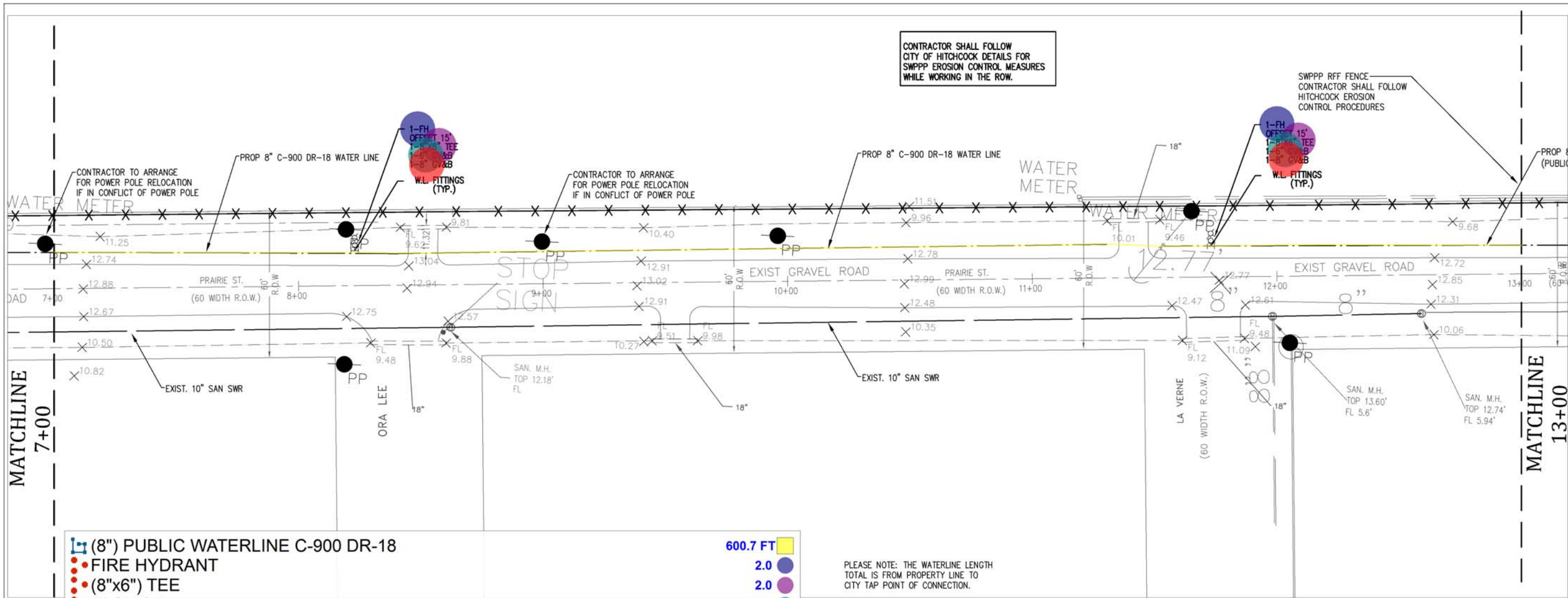

CONTRACTOR SHALL FOLLOW CITY OF HITCHCOCK DETAILS FOR SWPPP EROSION CONTROL MEASURES WHILE WORKING IN THE ROW.

SWPPP RFF FENCE  
CONTRACTOR SHALL FOLLOW HITCHCOCK EROSION CONTROL PROCEDURES

CONTRACTOR TO ARRANGE FOR POWER POLE RELOCATION IF IN CONFLICT OF POWER POLE

CONTRACTOR TO ARRANGE FOR POWER POLE RELOCATION IF IN CONFLICT OF POWER POLE

MATCHLINE 7+00

MATCHLINE 13+00

- (8") PUBLIC WATERLINE C-900 DR-18
- FIRE HYDRANT
- (8"x6") TEE
- 6" GV & B
- 8" GV & B

- 600.7 FT
- 2.0
- 2.0
- 2.0
- 2.0

PLEASE NOTE: THE WATERLINE LENGTH TOTAL IS FROM PROPERTY LINE TO CITY TAP POINT OF CONNECTION.

REVISIONS AND ISSUANCE		
NO.	DATE	DESCRIPTION

PROPRIETARY INFORMATION  
DESIGN INFORMATION CONTAINED HEREIN IS THE EXCLUSIVE PROPERTY OF JRH ENGINEERING, INC. NO PORTION OF ANY DESIGN INFORMATION CONTAINED HEREIN MAY BE USED BY, OR DISCLOSED TO, UNAUTHORIZED PERSONNEL WITHOUT EXPRESSED WRITTEN CONSENT.

ENCHANTED TRAILS RV PARK & RESORT  
0 F.M. 519 (MAIN STREET)  
HITCHCOCK, TX 77563



3/1/23

JRH ENGINEERING & ENVIRONMENTAL SERVICES, INC.  
820 S. FRIENDSWOOD DR. #202  
FRIENDSWOOD, TEXAS 77546  
PHONE: 281-482-8800  
TBPE FIRM NO. 10385

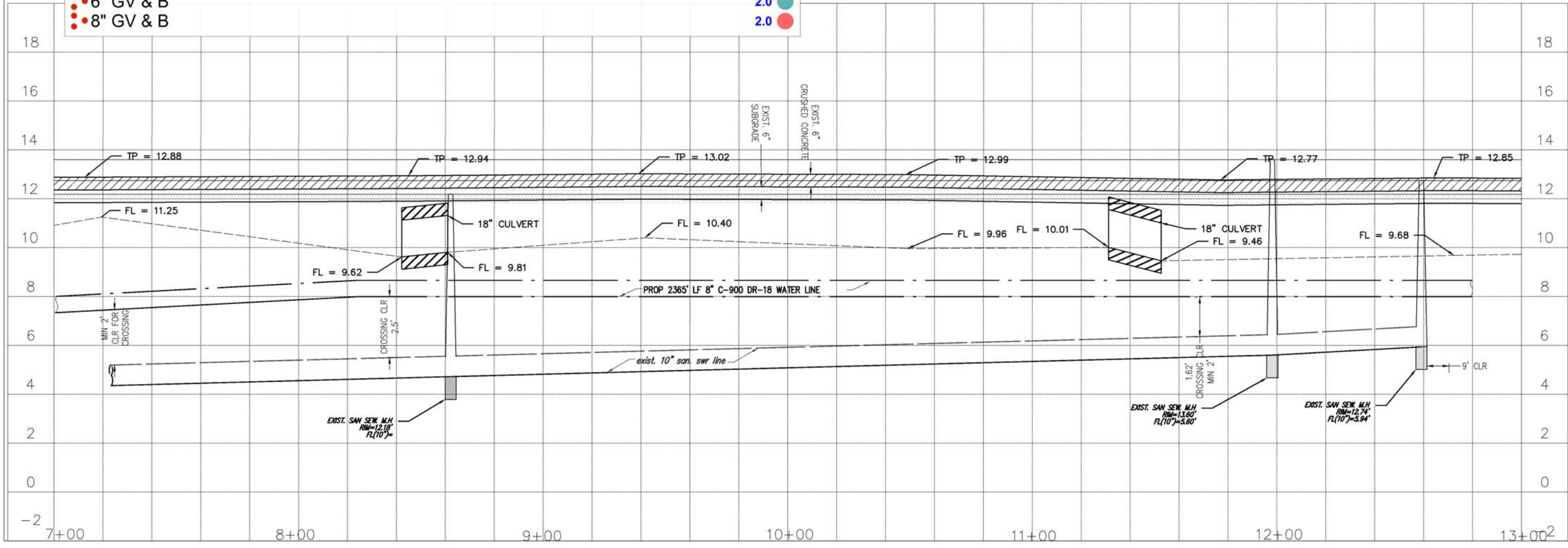

DRAWING TITLE	
PRAIRIE ST. WATER LINE	
STA 7+00 TO 13+00	
SCALE	CHECKED BY
1:20	
DATE	PROJECT #
3-27-2023	1403369
DRAWING NO.	
C20.7	

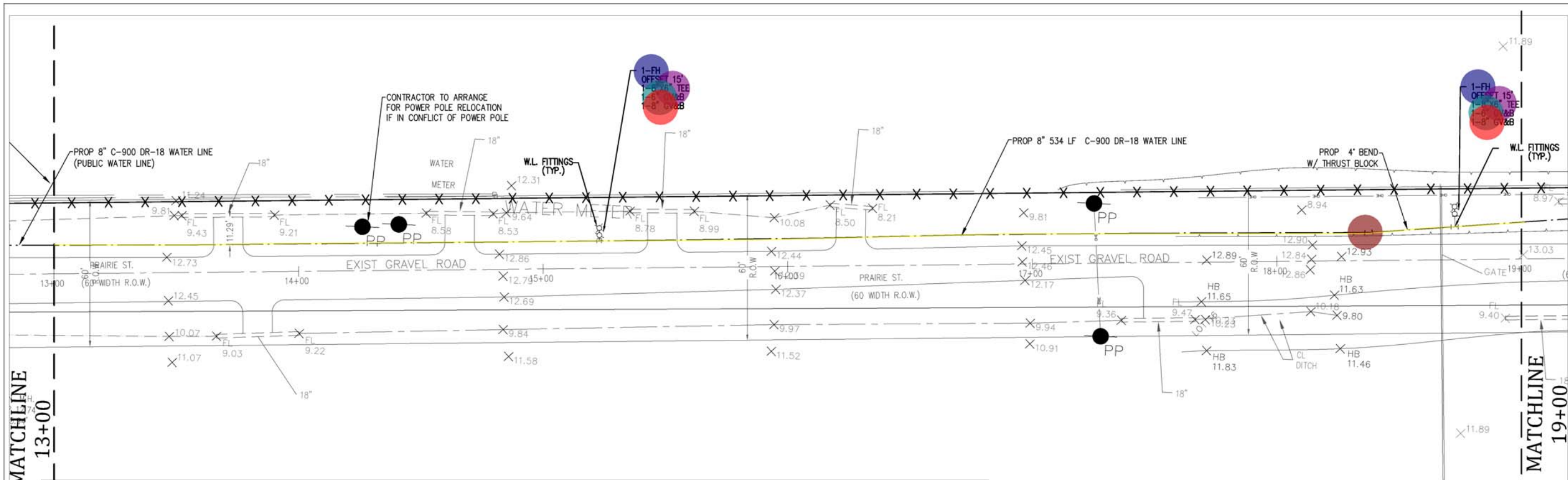

- (8") PUBLIC WATERLINE C-900 DR-18
- FIRE HYDRANT
- (8"x6") TEE
- 6" GV & B
- 8" GV & B
- 8" 45Deg BEND W/ THRUST BLOCK

- 601.6 FT
- 2.0
- 2.0
- 2.0
- 2.0
- 1.0

CONTRACTOR SHALL FOLLOW CITY OF HITCHCOCK DETAILS FOR SWPPP EROSION CONTROL MEASURES WHILE WORKING IN THE ROW.

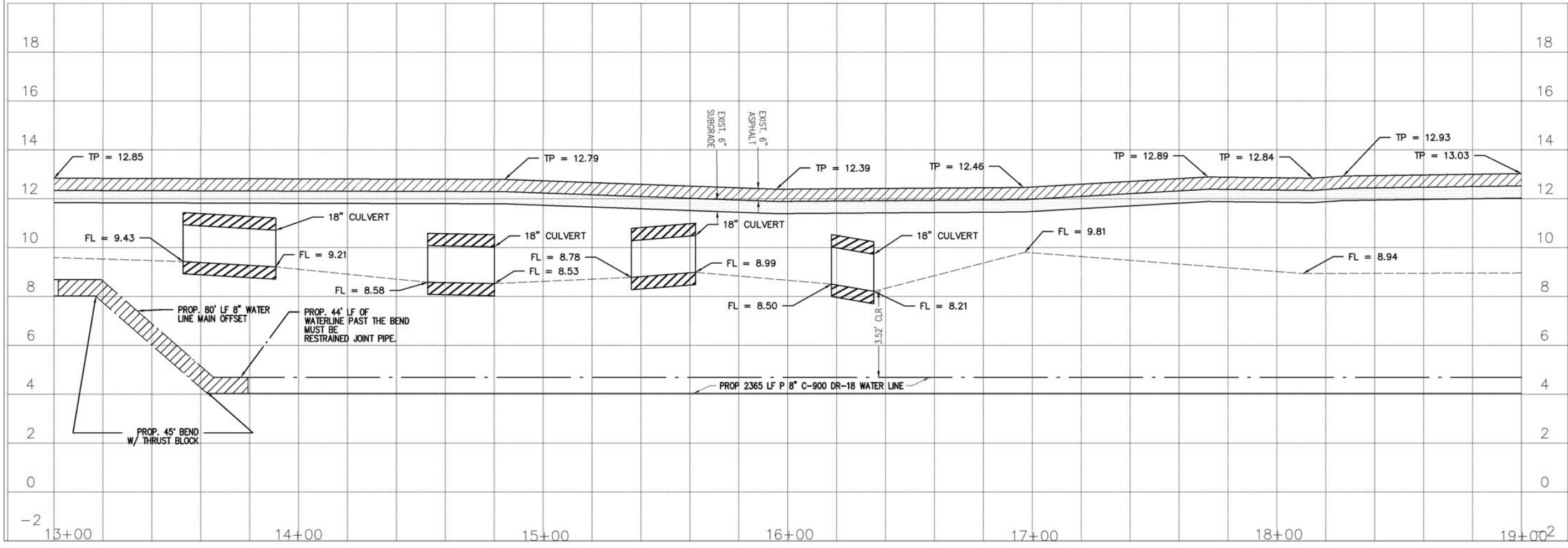

REVISIONS AND ISSUANCE		
NO.	DATE	DESCRIPTION

PROPRIETARY INFORMATION  
 DESIGN INFORMATION CONTAINED HEREIN IS CONFIDENTIAL AND IS THE EXCLUSIVE PROPERTY OF JRH ENGINEERING, INC. NO PORTION OF ANY DESIGN INFORMATION CONTAINED HEREIN MAY BE USED BY, OR DISCLOSED TO, UNAUTHORIZED PERSONNEL WITHOUT EXPRESSED WRITTEN CONSENT.

ENCHANTED TRAILS RV PARK & RESORT  
 0 F.M. 519 (MAIN STREET)  
 HITCHCOCK, TX 77563

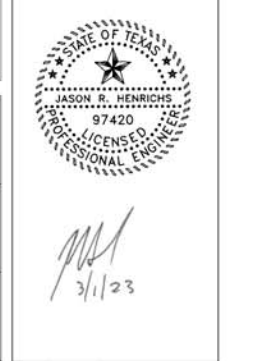

JRH ENGINEERING & ENVIRONMENTAL SERVICES, INC.  
 820 S. FRIENDSWOOD DR., #202  
 FRIENDSWOOD, TEXAS 77546  
 PHONE: 281-482-8800  
 TBPE FIRM NO. 10385

DRAWING TITLE  
**PRAIRIE ST. WATER LINE**  
 STA 13+00 TO 19+00  
 SCALE 1:20 CHECKED BY  
 DATE 3-27-2023 PROJECT # 1403369  
 DRAWING NO.  
**C20.8**

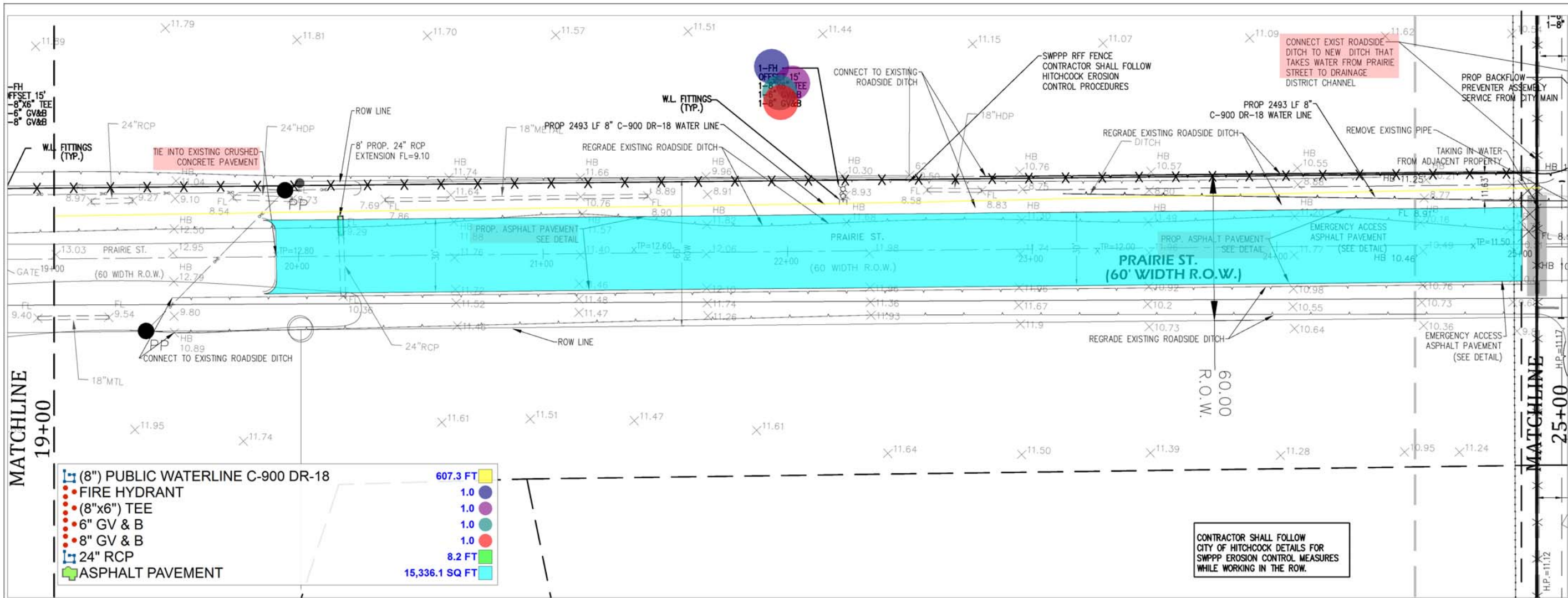

8" (8") PUBLIC WATERLINE C-900 DR-18	607.3 FT
FIRE HYDRANT	1.0
(8"x6") TEE	1.0
6" GV & B	1.0
8" GV & B	1.0
24" RCP	8.2 FT
ASPHALT PAVEMENT	15,336.1 SQ FT

CONTRACTOR SHALL FOLLOW CITY OF HITCHCOCK DETAILS FOR SWPPP EROSION CONTROL MEASURES WHILE WORKING IN THE ROW.

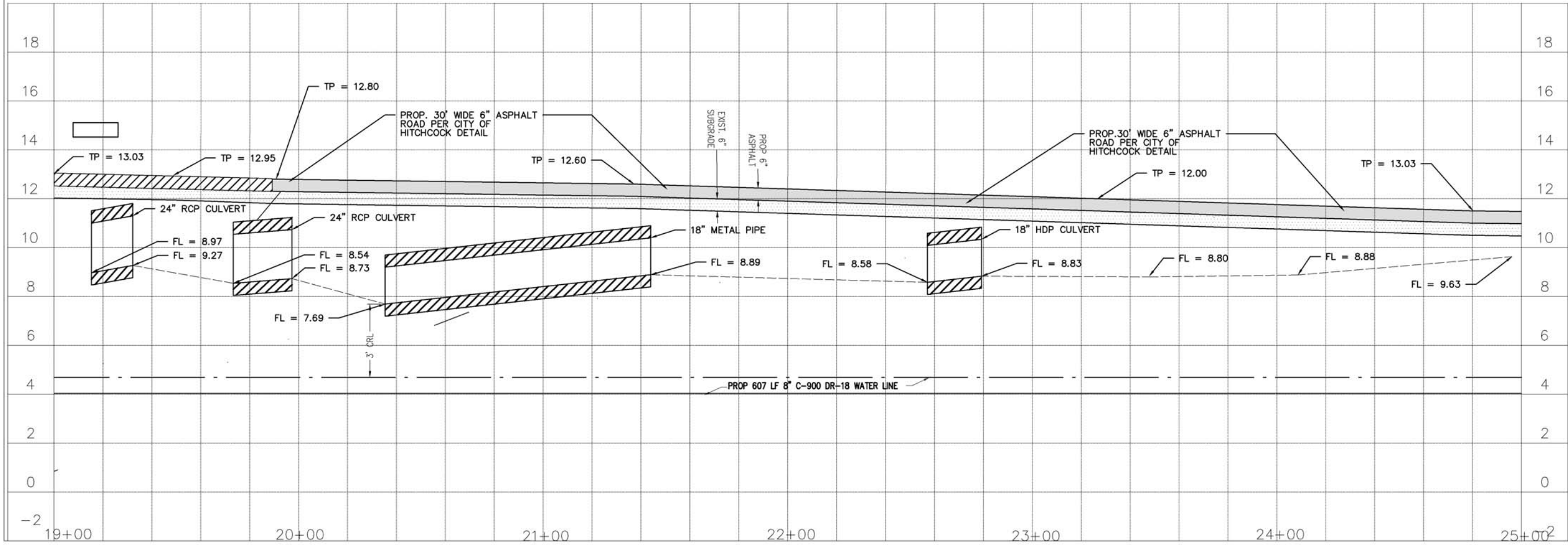

REVISIONS AND ISSUANCE		
NO.	DATE	DESCRIPTION

PROPRIETARY INFORMATION  
 DESIGN INFORMATION CONTAINED HEREIN IS THE EXCLUSIVE PROPERTY OF JRH ENGINEERING, INC. NO PORTION OF ANY DESIGN INFORMATION CONTAINED HEREIN MAY BE USED BY, OR DISCLOSED TO, UNAUTHORIZED PERSONNEL WITHOUT EXPRESSED WRITTEN CONSENT.

ENCHANTED TRAILS RV PARK & RESORT  
 0 F.M. 519 (MAIN STREET)  
 HITCHCOCK, TX 77563



4/24/23

**JRH ENGINEERING & ENVIRONMENTAL SERVICES, INC.**  
 820 S. FRIENDSWOOD DR., #202  
 FRIENDSWOOD, TEXAS 77546  
 PHONE: 281-482-8800  
 TBPE FIRM NO. 10385

DRAWING TITLE	
PRAIRIE ST. WATER LINE	
STA 19+00 TO 25+00	
SCALE	CHECKED BY
1:20	
DATE	PROJECT #
4-24-2023	1403369
DRAWING NO.	
C20.9	



NOTE: CONTRACTOR SHALL REFERENCE THE ROAD PROFILE & PAVING DETAILS AS WELL AS THE STRIPING AND ROAD MARKINGS FROM SHEETS 53.0-55.2.

PAVING EXPANSION DATA	STATION	STA ENDS	OFFSET LOCATION	PAVING EXPAN. OFFSET SF
BEGIN ROAD EXPANSION	11+14.58			
PAVING EXPANSION	12+00	12+00	VARIES EXIST. EDGE OF ROAD	5.37'
PAVING EXPANSION	13+00	13+00	VARIES EXIST. EDGE OF ROAD	8.64'
PAVING EXPANSION	14+00	14+00	VARIES EXIST. EDGE OF ROAD	11.63'
PAVING EXPANSION	15+00	15+00	VARIES EXIST. EDGE OF ROAD	13.59'
PAVING EXPANSION	16+00	16+00	VARIES EXIST. EDGE OF ROAD	13.14'
PAVING EXPANSION	17+00	17+00	VARIES EXIST. EDGE OF ROAD	12.80'
PAVING EXPANSION	18+00	18+00	VARIES EXIST. EDGE OF ROAD	12.69'
PAVING EXPANSION	19+00	19+00	VARIES EXIST. EDGE OF ROAD	12.63'
PAVING EXPANSION	20+00	20+00	VARIES EXIST. EDGE OF ROAD	09.87'
PAVING EXPANSION	21+00	21+00	VARIES EXIST. EDGE OF ROAD	5.78'
PAVING EXPANSION ENDS	21+36.00		EXIST. EDGE OF ROAD	
PAVING EXPANSION TOTAL				10,512

REVISIONS AND ISSUANCE		
NO.	DATE	DESCRIPTION

PROPRIETARY INFORMATION  
 DESIGN INFORMATION CONTAINED HEREIN IS THE EXCLUSIVE PROPERTY OF JRH ENGINEERING, INC. NO PORTION OF ANY DESIGN INFORMATION CONTAINED HEREIN MAY BE USED BY, OR DISCLOSED TO, UNAUTHORIZED PERSONNEL WITHOUT EXPRESSED WRITTEN CONSENT.

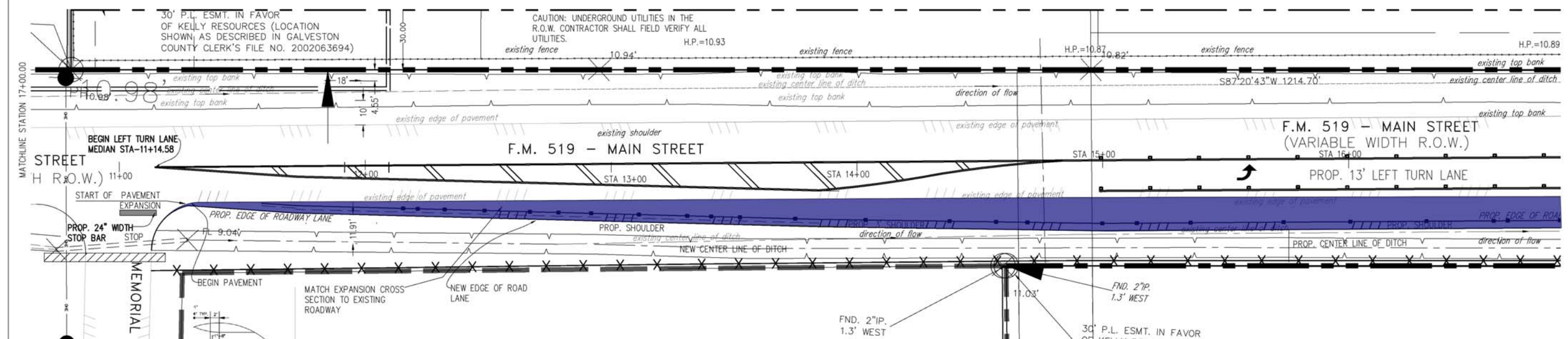
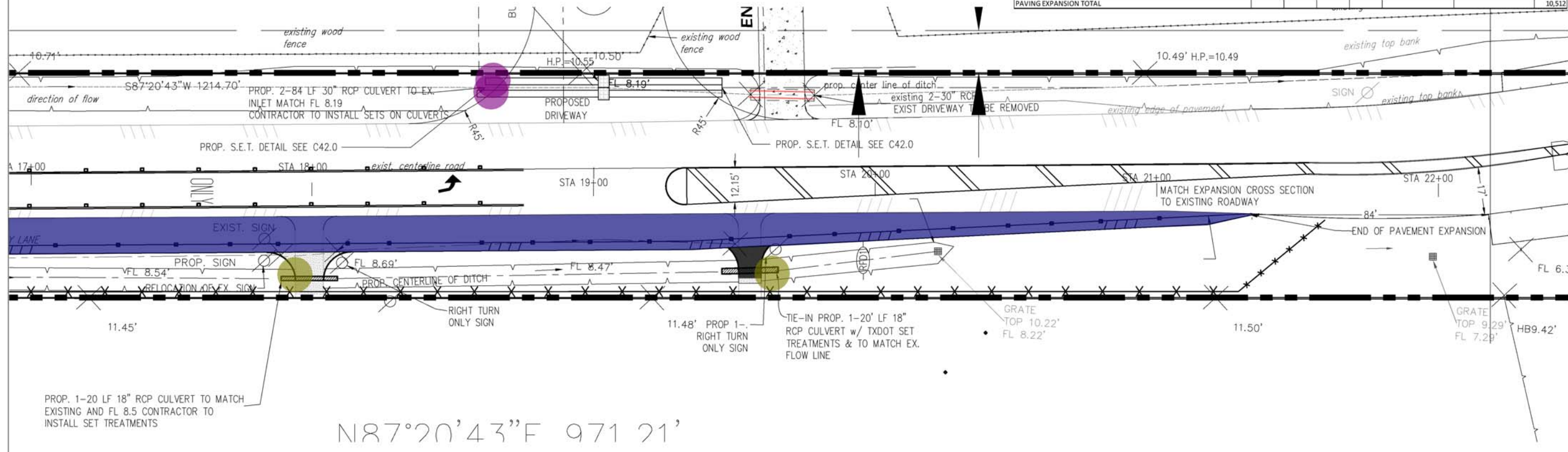

- 18" RCP x 20
- PAVEMENT EXPANSION
- 30" RCP CULVERT x 84
- REMOVE EXISTING 30" RCP CULVERT

2.0 ●  
 11,976.2 SQ FT ■  
 2.0 ●  
 53.2 FT ■

ENCHANTED TRAILS RV PARK & RESORT  
 0 F.M. 519 (MAIN STREET)  
 HITCHCOCK, TX 77563



3/1/23

JRH ENGINEERING & ENVIRONMENTAL SERVICES, INC.  
 820 S. FRIENDSWOOD DR., #202  
 FRIENDSWOOD, TEXAS 77546  
 PHONE: 281-482-8600  
 TELEX FIRM NO. 10385

DRAWING TITLE	
<b>PAVING EXPANSION</b>	
SCALE	CHECKED BY
1:30	
DATE	PROJECT #
3-27-2023	1403369
DRAWING NO.	
<b>C25.0</b>	

CAUTION: UNDERGROUND UTILITIES IN THE R.O.W. CONTRACTOR SHALL FIELD VERIFY UTILITIES.